

RESOLUTION # 53-94

A RESOLUTION FOR ADJUSTMENT OF SERVICE AREA BETWEEN EASTERN IOWA LIGHT & POWER COOPERATIVE AND BUFFALO MUNICIPAL ELECTRIC COMPANY:

WHEREAS: Four residences on Dodge Street are actually in the boundary area of Eastern Iowa Light & Power Cooperative, but Buffalo Municipal Electric Company has served the residences since 1960.

AND WHEREAS: It is mutually agreeable with Eastern Iowa Light & Power Cooperative and the Buffalo Municipal Electric Company to request the State of Iowa Utilities Board to adjust the boundary.

THEREFORE BE IT RESOLVED BY THE COUNCIL OF THE CITY OF BUFFALO, IA:

The City Council hereby requests the boundary change be made in agreement with Eastern Iowa Light & Power Cooperative in the above described area, and outlined in the enclosed letter to the Iowa State Utilities Board.

Passed by the Council of the City of Buffalo, IA this 05th day of December, 1994.

Approved and signed by the Mayor of Buffalo, IA this 05th day of December, 1994.

Signed: 

Phil C. Hoover,
Mayor of Buffalo, IA

Attest: 

Carol A. Bernauer,
City Clerk of Buffalo, IA

S T A T E O F I O W A

before the

I O W A S T A T E U T I L I T I E S B O A R D

PETITION FOR ADJUSTMENT OF SERVICE AREA BETWEEN EASTERN IOWA LIGHT & POWER COOPERATIVE AND BUFFALO MUNICIPAL ELECTRIC COMPANY	DOCKET NO. SPU-94 PETITION FOR ADJUSTMENT OF SERVICE AREA
--	---

PETITION

COMES NOW, Eastern Iowa Light and Power Cooperative (Eastern Iowa) and Buffalo Municipal Distribution and Light System (Buffalo Municipal) who jointly petition the Board to adjust the exclusive service area boundary between Eastern Iowa and Buffalo Municipal, and in support thereof state:

(1) That Buffalo Municipal has provided electric service to the residences located in this area as follows:

a) Charles W. Estes	Since 1960
b) Manuel M. Hutchinson	Since 1960
c) Bradford Hutchinson	Since 1960
d) Laura E. Pellin	Since 1960

(2) That Buffalo Municipal would realize a decrease of 26,210 KWH, or \$2,336.00 in annual revenue if Eastern Iowa were to provide electric service to the above mentioned Buffalo Municipal customers located within the exclusive area boundaries as presently described.

(3) Eastern Iowa would be required to construct 1,050 feet of electric facilities, duplicating those of Buffalo Municipal, at a cost of \$4,200.

(4) Eastern Iowa does not desire to serve these customers within Buffalo Municipals exclusive service area.

(5) Buffalo Municipal has indicated agreement with the proposed exclusive service area boundary.

(6) The proposed exclusive service area boundary modification is in the public interest in continuity of electric service and duplication of electric facilities.

WHEREFORE, Eastern Iowa Light and Power Cooperative prays the Board to revise the exclusive service area boundary as proposed.

Respectfully submitted,

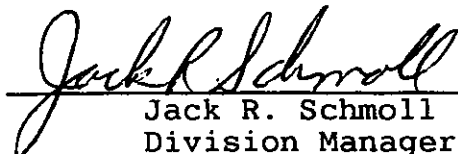

Jack R. Schmoll
Division Manager,
Member-Services

Eastern Iowa Light & Power Coop.
East Fifth and Sycamore Streets
Wilton, IA 52778

BUFFALO TOWNSHIP
SCOTT COUNTY, IOWA

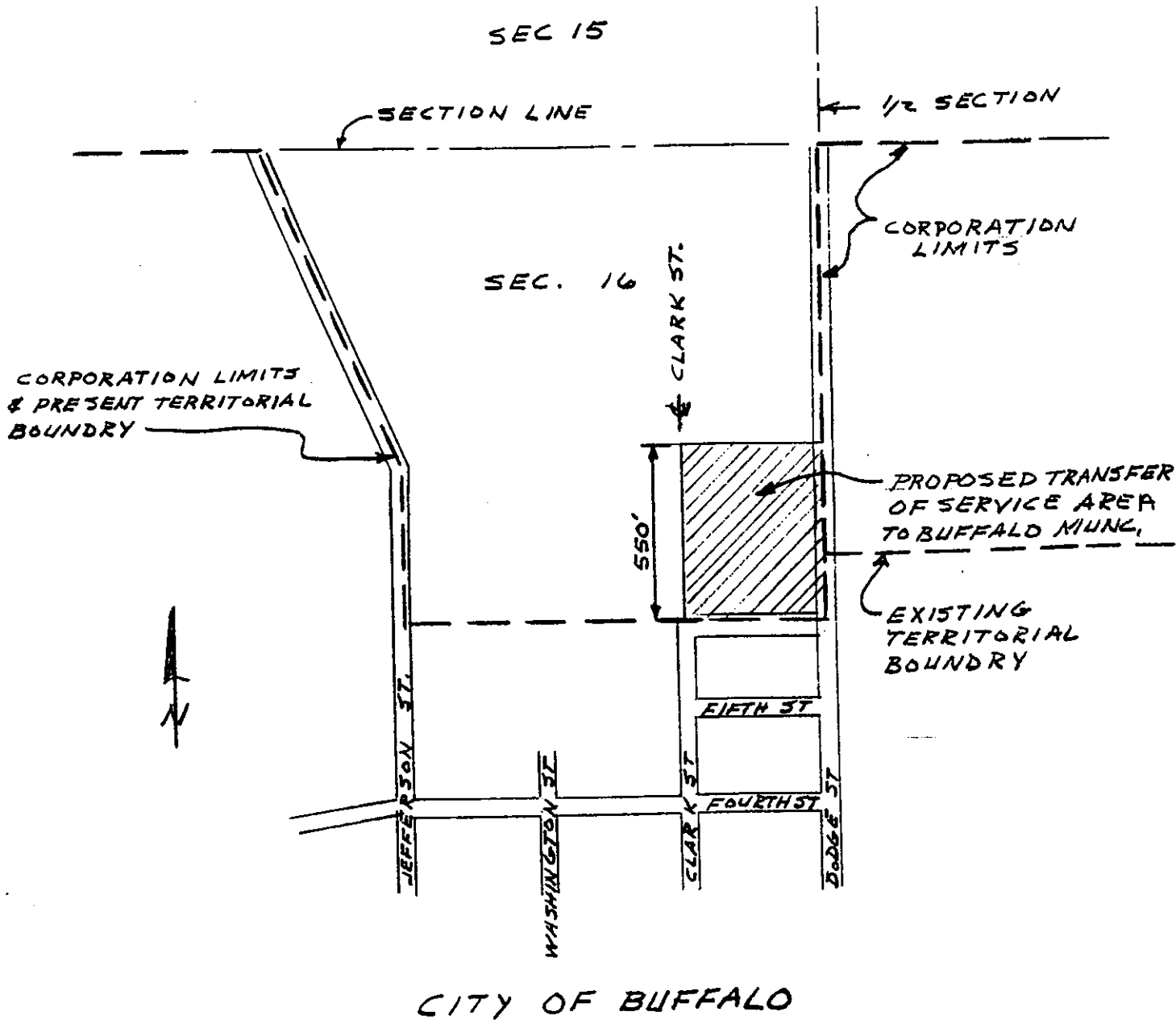

EASTERN IOWA LIGHT & POWER COOPERATIVE
WILTON IOWA

PETITION FOR ADJUSTMENT OF SERVICE AREA

DRAWN John Kutz DATE 5-18-88 SCALE 1"=40'
APPROVED _____ DATE _____ REVISED _____

DOCKET NO. SPU-94-
NO. 140-380